

ST. MARGARET^{of} YORK

Capital Campaign | 2016-2021



*"No one shall appear before the Lord empty handed,
but each of you with as much as he can give,
in proportion to the blessings which the Lord,
God has bestowed on you."*

Deuteronomy 16: 10, 16-17

Fulfilling the Great Commission

“Go, therefore, and make disciples of all nations, baptizing them in the name of the Father, the Son, and the Holy Spirit.”

- Matthew 28:19



Agenda

- ❖ Opening Prayer & Welcome
- ❖ Parish Demographics/Statistics
- ❖ Background & *Vision 2034*
- ❖ Next Steps
- ❖ Archdiocesan *One Faith, One Hope, One Love* campaign
- ❖ Questions & Answers
- ❖ Closing Prayer



SMOY Parish Households

PARISH Registered Households

2008	1,794
2009	1,825
2010	1,858
2011	1,892
2012	1,938
2013	1,985
2014	1,959
2015	1,939



SMOY Parish Household Giving

DATA AS OF 9/2015

Registered Households	1,939
Total Parishioners	7,214
Households Financially Supporting the Parish	1,135 (59%)
FY'14 Offerings	\$1,548,278.69
FY'15 Offerings	\$1,600,094.74
FY'16 Offerings YTD (9/22/15)	\$340,172.00



October Counts – *Mass Attendance*

DAY	TIME	2008	2009	2010	2011	2012	2013	2014
Saturday	4:30pm	2,092	2,085	2,863	2,550	2,320	2,385	2,292
Sunday	9:00am	3,084	3,225	4,349	3,460	3,102	2,821	4,223
Sunday	11:00am	3,923	4,257	5,520	4,767	4,361	4,849	4,280
Sunday	5:30pm						1,992	2,286
Weddings	Sat after 3:00 pm	595			970		180	
Totals		9,694	9,567	12,732	11,747	9,783	12,227	13,081
Weekly Average		2,424	2,392	2,546	2,350	2,446	3,057	3,270

Background Information

What has brought us to this point in the journey?



*Honor the Lord with your wealth, with first
fruits of all you produce; then will your barns
be filled with grain, with new wine your vats
will overflow."*

Proverbs 3:9



Background Information

- ❖ **Gallup - ME25 Survey** **2012**
 - ❖ Measured depth of engagement/commitment of parishioners to the parish community
- ❖ **Parish Life Survey** **2013**
 - ❖ Identified ministerial as well as “brick & mortar” needs
 - ❖ based on Parishioner’s feedback
- ❖ **Parish Census** **2013/2014**
 - ❖ Identified actual number of Parishioner Households

Based on the above findings the Pastoral Staff began planning for a much needed Capital Campaign



Background Information

Archdiocesan Capital Campaign Announced

June 2014

Pastoral Staff/Pastor decide to forego a Parish Capital Campaign due to the Archdiocesan needs

July 2014

After reviewing parish needs, Pastoral Council unanimously decides that it is important for the parish to move forward with a Capital Campaign

September 2014



VISION 2034

- ❖ **Parish Developed an Architectural Master Plan**
working with *CR Architects* of Cincinnati

2014/2015

- ❖ Identified needs for Church, School and Campus
- ❖ \$25,000,000.00 (2015 Dollars) with allowance for furnishings



V I S I O N 2034



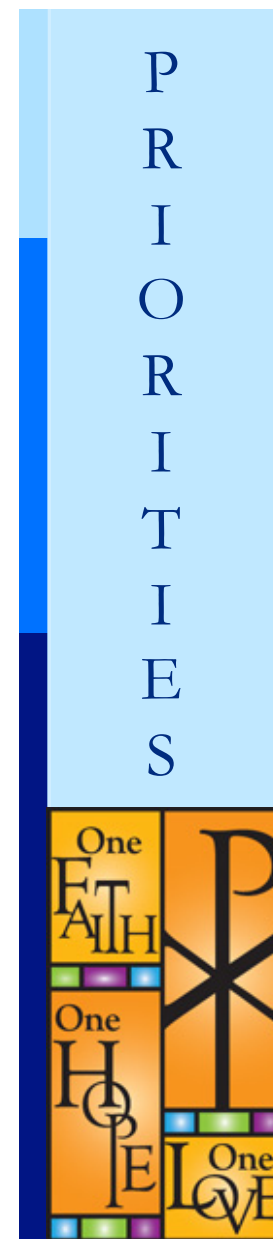

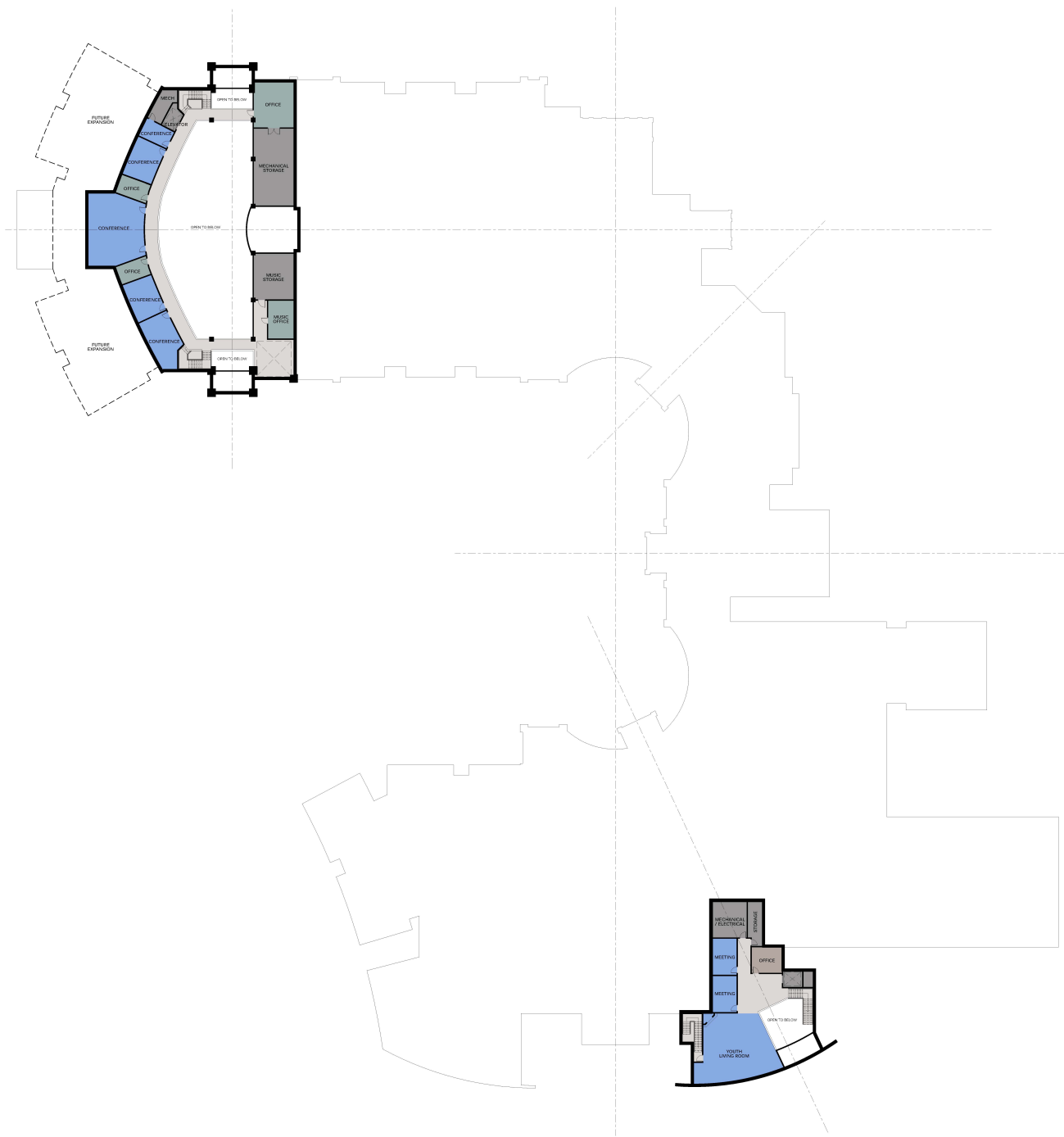

P R I O R I T I E S



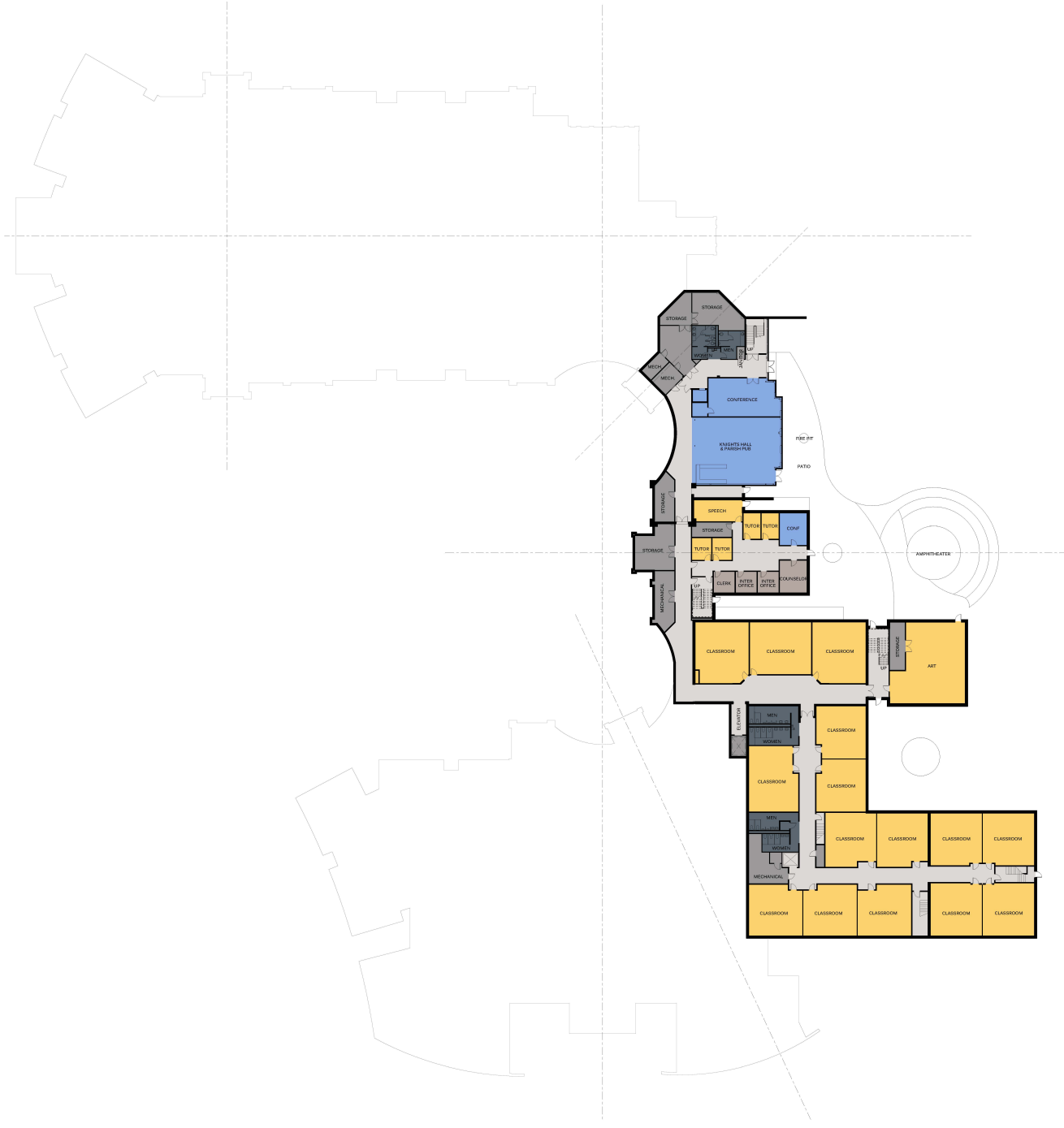

P
R
I
O
R
I
T
I
E
S





Why A Capital Campaign Now!

- ❖ **Archdiocese of Cincinnati**
 - ❖ “*One Faith, One Hope, One Love*” Campaign
 - ❖ **\$1,860,000**



Archdiocesan Campaign Background

Our Archdiocese Includes:

- 480,000 Catholics
- 160,000 registered households
- 211 parishes
- 111 schools
- 275 diocesan priests
- 237 religious order priests
- 201 permanent deacons
- 1,001 religious sisters and brothers

